

AKE90-8 KV35, $\Phi 107.5 \times 43.5$ mm

PRODUCT DRAWING

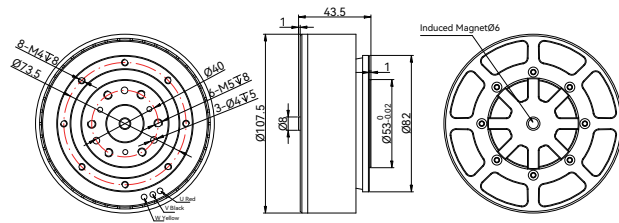

ANALYTICAL GRAPH OF MOTOR OPERATION

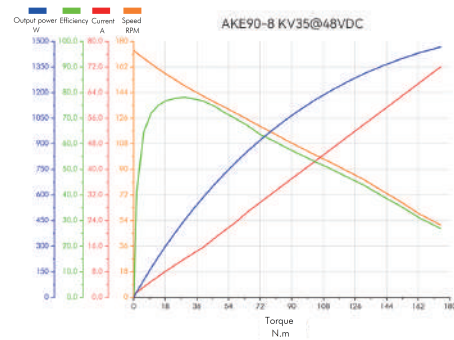

SPECIFICATIONS

Application	Cobot Arm	Peak torque (Nm)	170
Driving way	FOC	Peak current (ADC)	72
Operation ambient temperature (°C)	-20~50	Kv (rpm/V)	35
Winding type	delta	Kt (Nm/A)	0.272
Insulation class	H	Ke (V/krpm)	0.0285
Insulation High-voltage (V)	1000	Phase to Phase resistance (mΩ)	164
Insulation Resistance (MΩ)	10	Phase to Phase inductance (μH)	235
Pole pairs	21	Inertia (gcm ²)	3377.08
Arcmin	9	Km (Nm/√W)	0.67372
Rated voltage (V)	48	Mechanical time constant (ms)	2.18
No-load speed (rpm)	210	Electrical time constant (ms)	1.4329
Rated torque (Nm)	55	Weight (g)	1400
Rated speed (rpm)	120	Maximum torque weight ratio (Nm/kg)	121.4
Rated current (ADC)	21	Reduction Ratio	8:1