

RI50 KV100, $\Phi 54*27$ mm

PRODUCT DRAWING

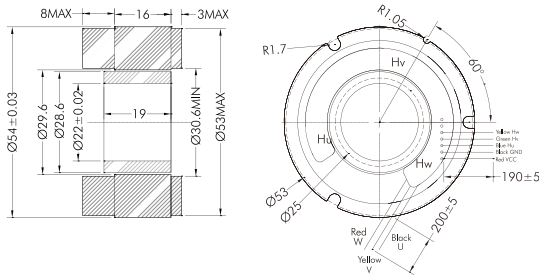

ANALYTICAL GRAPH OF MOTOR OPERATION

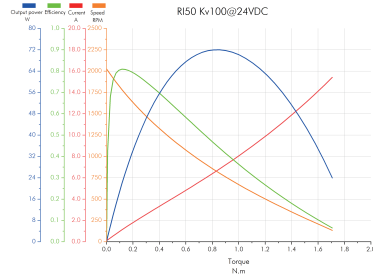

SPECIFICATIONS

Application	Cobot arm/exoskeleton	Insulation class	C
Driving way	FOC	Insulation High-voltage	500V 5mA/2s
Operation ambient temperature	-20°C~50°C	Insulation resistance	500V10M Ω
Winding type	star	Phase	3
		Pole pairs	7

ELECTRIC PARAMETERS

Rated voltage (V)	24/36/48	Ke (V/krpm)	11.41
No-load speed (rpm)	2004/3006/4008	Phase to Phase resistance (m Ω)	1420
Rated torque (Nm)	0.58	Phase to Phase inductance (μ H)	1500
Rated speed (rpm)	1090/1860/2600	Inertia (gcm ²)	22.8
Rated current (ADC)	4.8	Km (Nm/ \sqrt W)	0.1007
Peak torque (Nm)	1.67	Mechanical time constant (ms)	0.22
Peak current (ADC)	14.8	Electrical time constant (ms)	1.06
Kv (rpm/V)	100	Weight (g)	180.8
Kt (Nm/A)	0.120	Maximum torque weight ratio (Nm/kg)	9.24

CONNECTOR

U	Black+18#Silicone Wire	Hv	Green+30#Silicone Wire
V	Yellow+18#Silicone Wire	Hw	Yellow+30#Silicone Wire
W	Red+18#Silicone Wire	VCC GND	Red+30#Silicone Wire
Hu	Blue+30#Silicone Wire	correspondence	Black+30#Silicone Wire
			Hu-U Hv-V Hw-W